



*New- and Redesign of the School Facility Wilhelm-Dörpfeld Grammar School, Wuppertal*

## NEW PRESENCE

### *Concept*

In the direct vicinity of outstanding buildings such as the Schwimmoper, a swimming pool designed by Friedrich Hetzelt or the historic Stadthalle (city hall), the Wilhelm Dörpfeld Grammar School forms the closure of the park-like area in the east, on the crest of the Johannisberg. The tranquil and light design, as well as clear, restructured spatial concepts, create a high quality utilisation and promote the learning ambience in the outdoor areas of school. The dense „forest“ on the slope, surrounding the school site, will be transformed consistently into a park landscape with active and passive zones, providing a wide range of educational or recreational facilities in the spirit of a „green classroom“.

A consistent thinning-out process will expose sections of the facade on the north side. The main entrance will be broadened, creating views between the interior and the exterior, hence increasing the level of perceptibility of the school within the urban space. An additional stairway in the northeast ensures that the school site opens up towards the city centre and the surrounding districts.

Along the edge of the site, a broad, horizontally shaped hedge defines the boundary between the interior and exterior space. Central hedge elements with integrated seating elements, outdoor furniture and broad seating steps on the slope take up the idea of a „shared centre“. They provide diverse opportunities for communication, individual activities, movement and outdoor learning.

### *Client*

FACILITY MANAGEMENT CITY OF WUPPERTAL

### *Project period*

2015 - 2018

### *Size*

9.250 m<sup>2</sup>

### *Type*

PUBLIC SPACES & SQUARES

### *Location*

WUPPERTAL, GERMANY

### *Competition*

1ST PLACE VOF PROPERTY PLANNING FOR OPEN SPACES  
ARCHITECTURE PRIZE WUPPERTAL 2020 - RECOGNITION

### *Realisation*

WES LANDSCAPEARCHITECTURE

### *Partner*

HEUER FAUST ARCHITEKTEN, AACHEN

### CONTACT

Jarrestraße 80  
22303 Hamburg  
Germany

Telephone +49 (0) 40 2 78 41-0  
Telefax +49 (0) 40 270 66 68  
hamburg@wes-la.de

### FOR MORE INFORMATION AND PRESS MATERIAL

Telephone +49 (0) 40 2 78 41-153  
Telefax +49 (0) 40 270 66 68  
pr@wes-la.de

*Project Images*



CONTACT

Jarrestraße 80  
22303 Hamburg  
Germany

Telephone +49 (0) 40 2 78 41-0  
Telefax +49 (0) 40 270 66 68  
hamburg@wes-la.de

FOR MORE INFORMATION AND PRESS MATERIAL

Telephone +49 (0) 40 2 78 41-153  
Telefax +49 (0) 40 270 66 68  
pr@wes-la.de

*Project Images*



CONTACT

Jarrestraße 80  
22303 Hamburg  
Germany

Telephone +49 (0) 40 2 78 41-0  
Telefax +49 (0) 40 270 66 68  
hamburg@wes-la.de

FOR MORE INFORMATION AND PRESS MATERIAL

Telephone +49 (0) 40 2 78 41-153  
Telefax +49 (0) 40 270 66 68  
pr@wes-la.de

Project Images

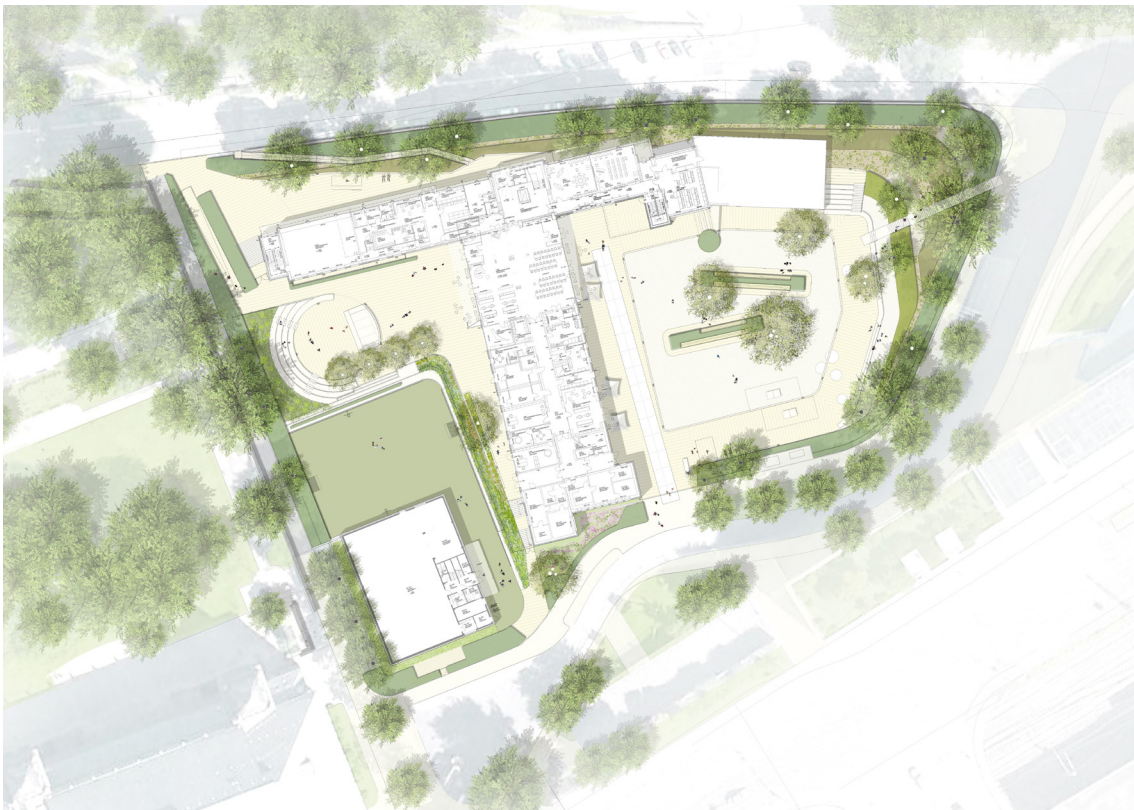

CONTACT

Jarrestraße 80  
22303 Hamburg  
Germany

Telephone +49 (0) 40 2 78 41-0  
Telefax +49 (0) 40 270 66 68  
hamburg@wes-la.de

FOR MORE INFORMATION AND PRESS MATERIAL

Telephone +49 (0) 40 2 78 41-153  
Telefax +49 (0) 40 270 66 68  
pr@wes-la.de

## *Legal notice*

WES GmbH  
LandschaftsArchitektur (LandscapeArchitecture)

Managing Shareholders:  
Wolfgang Betz  
Michael Kaschke  
Henrike Wehberg-Krafft  
Claus Rödding

District court Hamburg HRB 100420

Person responsible for content according to  
§ 55 Abs. 2 RStV: Wolfgang Betz (address as above)

The rules of professional conduct are specified in:  
(1) Law for Architects Hamburg  
(2) Statute of Hamburg Chamber of Architects

The professional regulations can be viewed and  
accessed via the website of the Hamburg Chamber of  
Architects [www.akhh.de](http://www.akhh.de) / Section: Recht (legal issues).

The legal occupational title "Landschaftsarchitekt"  
(landscape architect) was awarded to PartG mbB  
Schatz Betz Kaschke Wehberg-Krafft Rödding in Ger-  
many following their entry in the list of architects of the  
Hamburg Chamber of Architects.

Hamburgische Architektenkammer  
(Hamburg Chamber of Architects)  
Grindelhof 40  
20146 Hamburg  
Telephone: +49 (0)40 441841-0  
Telefax: +49 (0)40 441841-44  
[info@akhh.de](mailto:info@akhh.de)  
[www.akhh.de](http://www.akhh.de)

## *Copyright*

The contents and works produced by the site operator  
are subject to German copyright laws. The duplication,  
editing, distribution and any kind of use beyond what  
is permitted by the copyright laws requires written  
authorisation from the respective author or content  
creator.

## *Image rights*

WES GmbH LandscapeArchitecture owns the unlimi-  
ted usage rights and non-exclusive rights for all of the  
image material that appears in this document.

In the context of the use of the external image material  
we are exempt from any claims by third parties. WES  
GmbH LandscapeArchitecture is not liable for images  
provided by the project partners.

By providing image material, the project partners  
avouch that they have unrestricted use of the image  
material, that it is not subject to rights by third parties,  
the persons pictured consent to the publication and  
that no fees must be paid for this.

## *Link to photographers*

Photos:  
Jörg Hempel  
[www.joerg-hempel.com](http://www.joerg-hempel.com)  
WES LandschaftsArchitektur  
[www.wes-la.de](http://www.wes-la.de)

Siteplan:  
WES LandschaftsArchitektur  
[www.wes-la.de](http://www.wes-la.de)

## CONTACT

Jarrestraße 80  
22303 Hamburg  
Germany

Telephone +49 (0) 40 2 78 41-0  
Telefax +49 (0) 40 270 66 68  
[hamburg@wes-la.de](mailto:hamburg@wes-la.de)

## FOR MORE INFORMATION AND PRESS MATERIAL

Telephone +49 (0) 40 2 78 41-153  
Telefax +49 (0) 40 270 66 68  
[pr@wes-la.de](mailto:pr@wes-la.de)